

CURIUM ANCIENT THEATRE | LIMASSOL

OVERVIEW ▼

Please note that the venue is an archaeological site protected by the Department of Antiquities. Hence there are strict limitations for the setup, especially regarding the alteration or damage to any part of the site.

SEATING ▼

There is a ranked auditorium with a capacity of 1,500 people.

THE STAGE ▼

The stage is semi-circular with a radius of 7 m and an extension of 19.5 x 6 m. A detailed floor plan (Rate 1:50) follows.

CANOPY ▼

A canopy is not available. Since this is an archaeological site, special licenses need to be acquired for any sort of intervention in the space.

MASKING ▼

There is no masking.

SUSPENSION ▼

The suspension will be custom-made using a group support system.

LIGHTING ▼

Absolute dark is not feasible as this is an open-air venue.

The lighting control position is located at the rear of the auditorium.

Lanterns are rigged as per the supplied diagram.

Additional lanterns can be added according to production needs.

Final plan and equipment list changes at the beginning of the season (May each year), and productions will be informed accordingly.

SOUND ▼

The sound control position is located at the rear of the auditorium.

The control system will be according to the specifications of the show.

SURTITLES ▼

All performances are provided with surtitles. Led surtitle screen /s is adjusted to the specifications of the show scenery.

CURIUM ANCIENT THEATRE | LIMASSOL

DRESSING ROOM / WARM-UP AREA ▼

Two build up dressing rooms are available with a capacity of 10 persons each.

Mobile dressing room/s are also set up for the show requirements.

A open space warm-up area is available.

There are toilet and shower facilities available.

Tables, chairs and mirrors are provided for communal use. Although every measure will be taken, the management cannot accept responsibility for the security of any items left in the dressing room.

STORAGE ▼

Small items of scenery and props may be stored in the dressing room at the discretion of the Technical Manager. There is no capacity to store large items of set. Backstage storage is extremely limited and we recommend that companies keep their scenery/props requirements to an absolute minimum. It is not possible to provide storage space in other parts of the area.

In the event that the scenery is transported within a container, the container can remain on-site. The Management is not responsible for any loss or damage to any props, costumes, equipment left on site.



INTERNATIONAL
FESTIVAL OF ANCIENT
GREEK DRAMA

CURIUM ANCIENT AMPHITHEATRE

FLOOR PLAN | RATE: 1:50

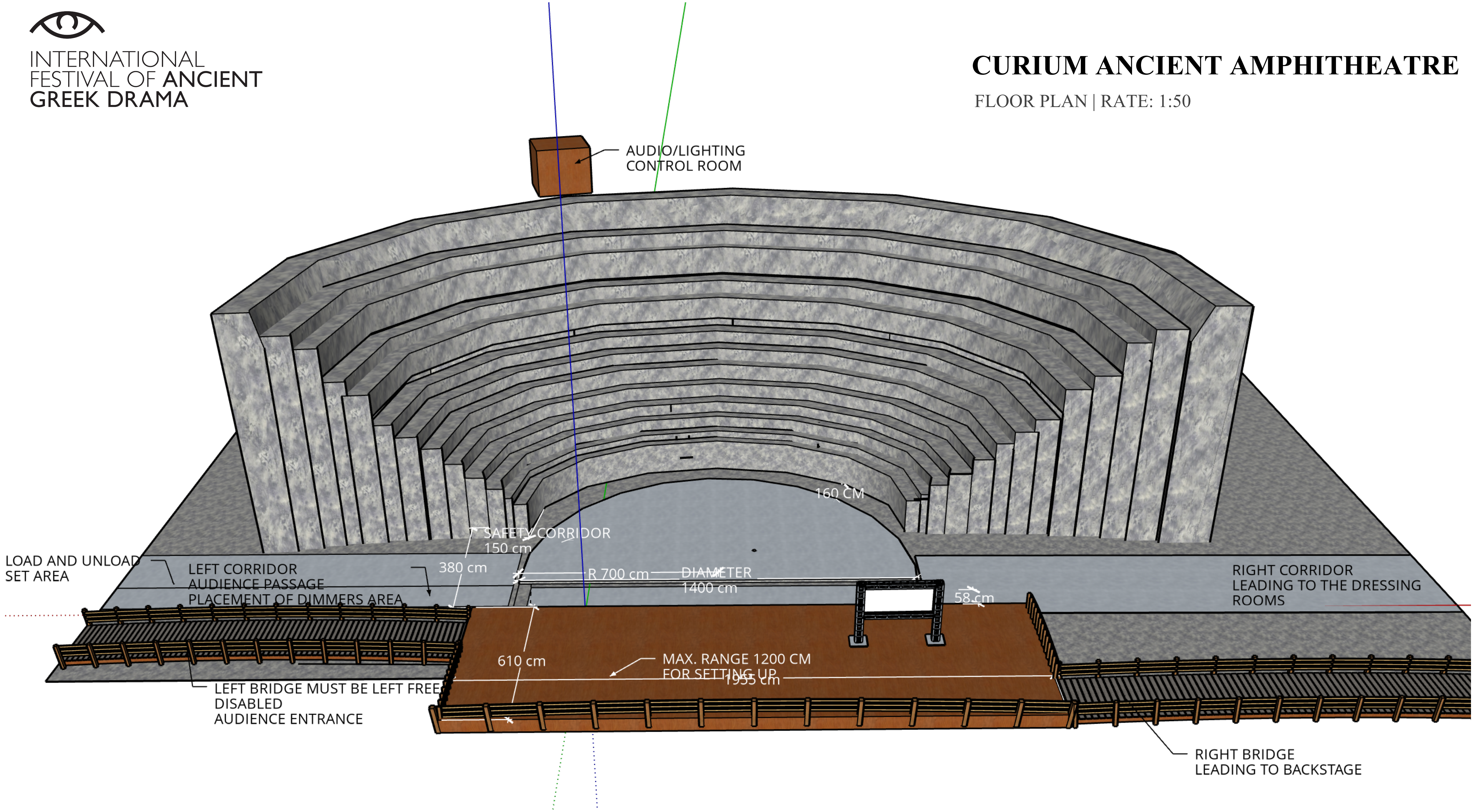



INTERNATIONAL
FESTIVAL OF ANCIENT
GREEK DRAMA

CURIUM ANCIENT AMPHITHEATRE

FLOOR PLAN | RATE: 1:50

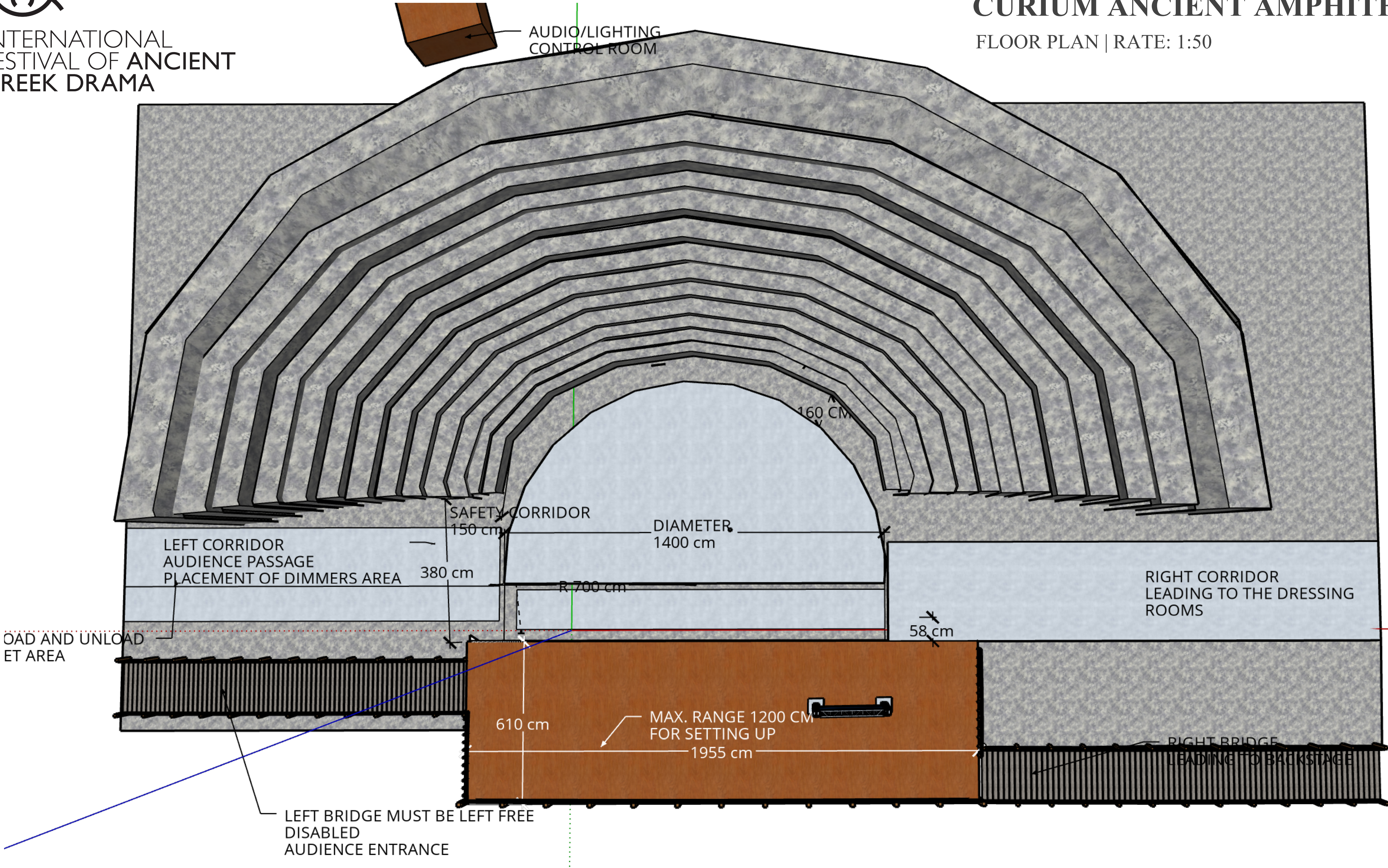



INTERNATIONAL
FESTIVAL OF ANCIENT
GREEK DRAMA

CURIUM ANCIENT AMPHITHEATRE

FLOOR PLAN | RATE: 1:50

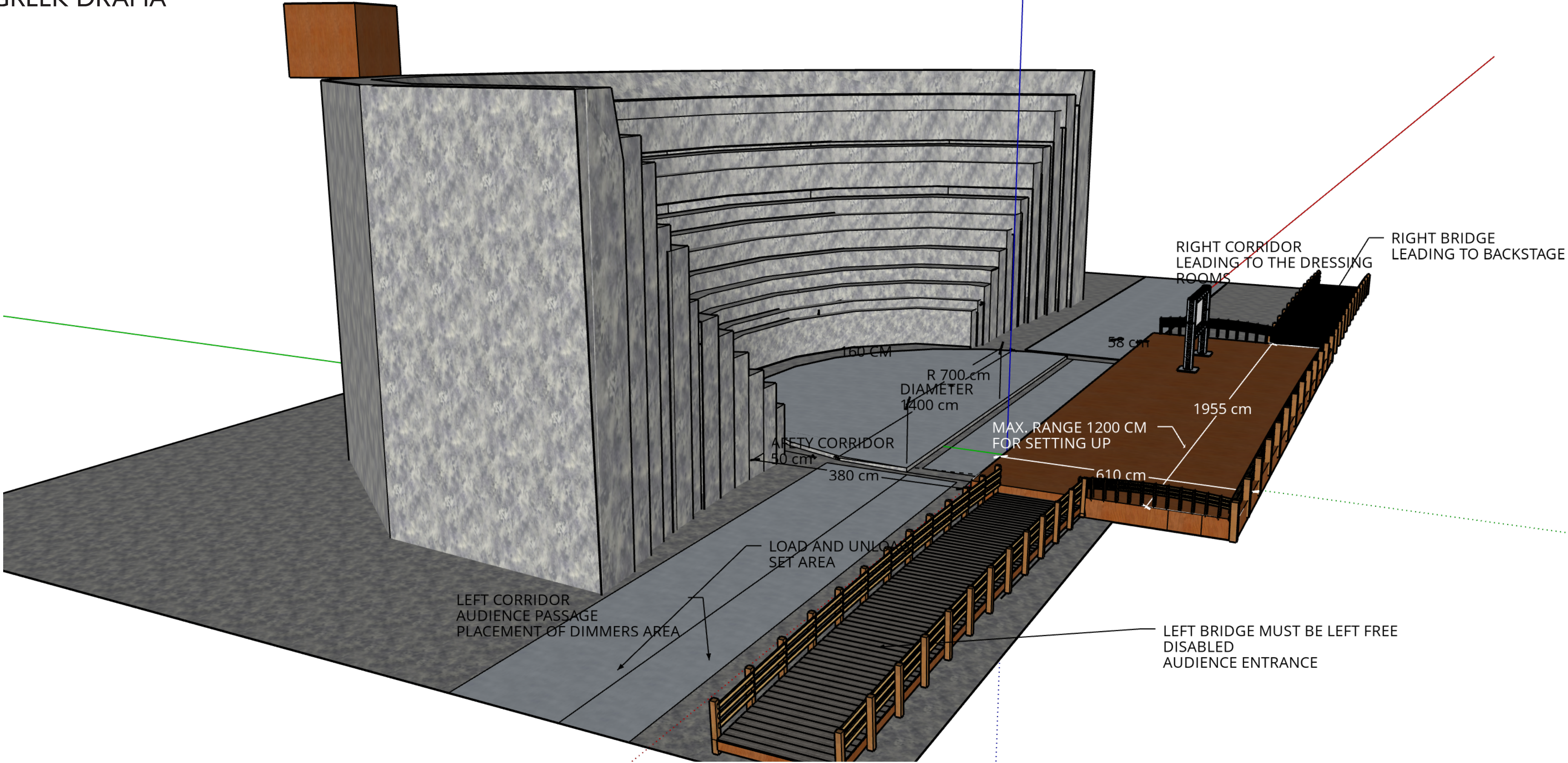



INTERNATIONAL
FESTIVAL OF ANCIENT
GREEK DRAMA

CURIUM ANCIENT AMPHITHEATRE

FLOOR PLAN | RATE: 1:50

RIGHT BRIDGE
LEADING TO BACKSTAGE

RIGHT CORRIDOR
LEADING TO THE DRESSING
ROOMS

LEFT BRIDGE MUST BE LEFT FREE
DISABLED
AUDIENCE ENTRANCE

1955 cm

MAX. RANGE 1200 CM
FOR SETTING UP

610 cm

58 cm

R 700 cm

DIAMETER
1400 cm

SAFETY CORRIDOR
150 cm

380 cm

AUDIO/L
CONTROL



INTERNATIONAL
FESTIVAL OF ANCIENT
GREEK DRAMA

CURIUM ANCIENT AMPHITHEATRE

FLOOR PLAN | RATE: 1:50

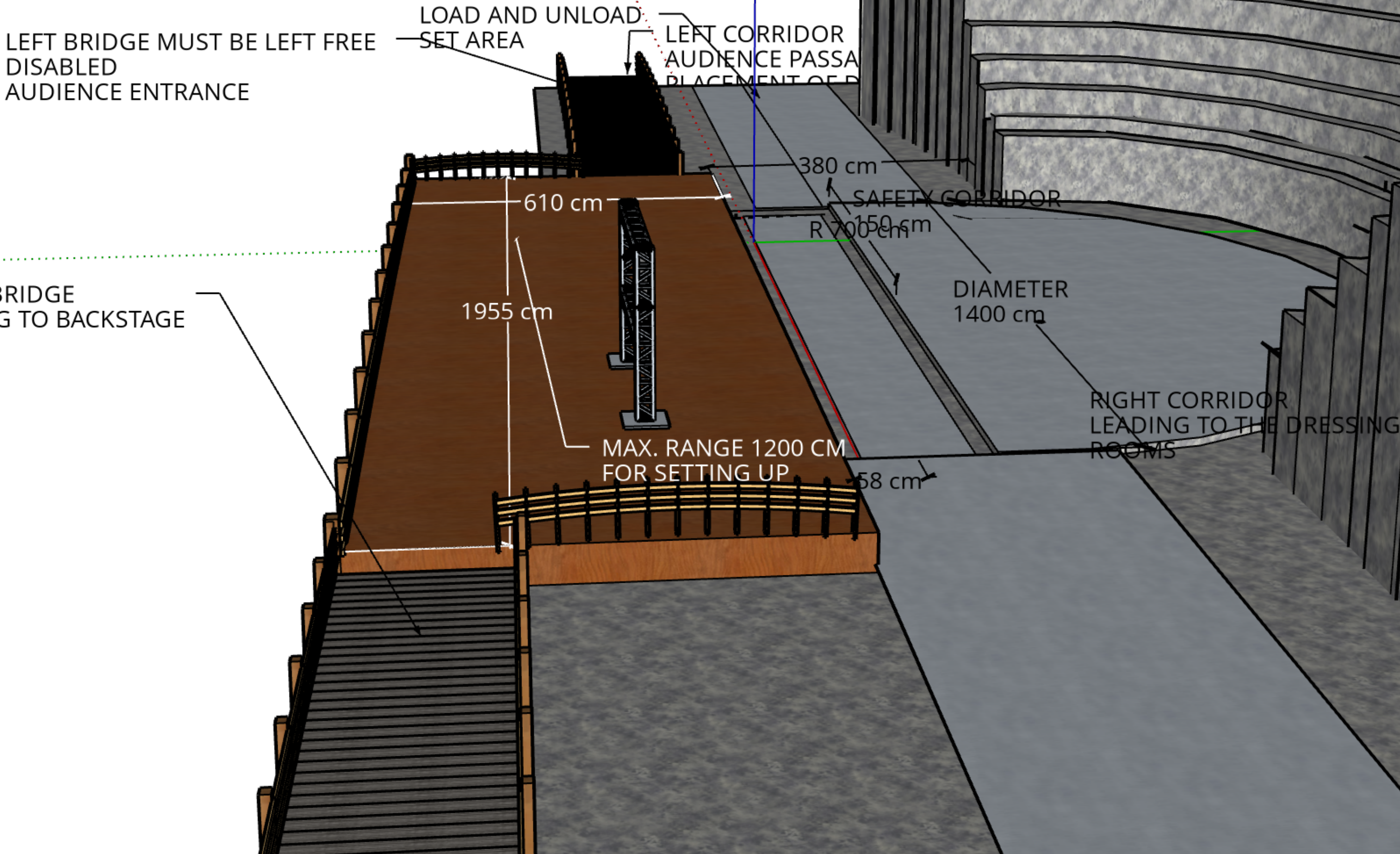



CURIUM ANCIENT THEATRE | LIMASSOL
INTERNATIONAL FESTIVAL OF ANCIENT GREEK DRAMA

CURIUM ANCIENT THEATRE | LIMASSOL

INTERNATIONAL FESTIVAL OF ANCIENT GREEK DRAMA



CURIUM ANCIENT THEATRE | LIMASSOL

INTERNATIONAL FESTIVAL OF ANCIENT GREEK DRAMA

